

Western Washington University (WWU) makes these documents available on an "as is" basis. All warranties and representations of any kind with regard to said documents are disclaimed, including the implied warranties of merchantability and fitness for a particular use. WWU does not warrant the documents against deficiencies of any kind.

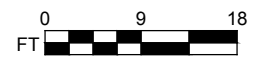

TRUE NORTH



<h2 style="margin: 0;">VIKING COMMONS</h2> <p style="margin: 0;">FLOOR 5</p>	Last Sync With FAMIS: 02/05/2016
Date Revised: 05/24/2016	

VC
Floor #
5

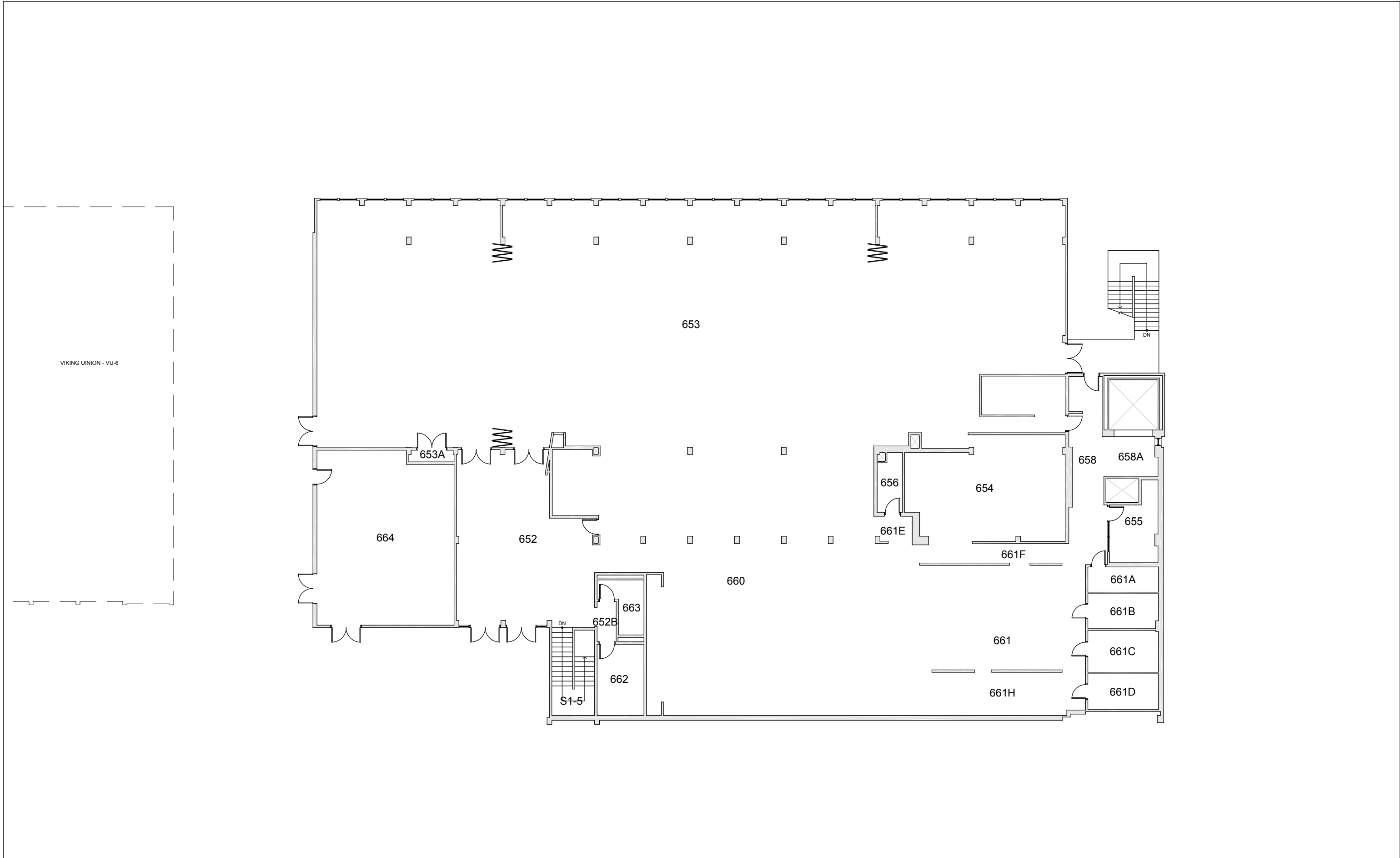

Western Washington University (WWU) makes these documents available on an "as is" basis. All warranties and representations of any kind with regard to said documents are disclaimed, including the implied warranties of merchantability and fitness for a particular use. WWU does not warrant the documents against deficiencies of any kind.



VIKING COMMONS
FLOOR 6

Date Revised: 05/24/2016 Last Sync With FAMIS: 02/05/2016

Building/Zone	VC
Floor #	6